

Service Information no. 195b

Chameleon Pumps and Pump columns **NEW ITEM NOS.**

Due to the fact that the controller is mounted on the pump motor, it is easier to exchange the pump column rather than the entire pump inclusive motor. Due to this we have decided to introduce some standard pump columns in our warehouse, which urgently can be shipped as spare parts.

Chameleon pump columns without motor



Item No.	Item text
NA. 110001733 EBS 10097543	CRN 3-9+ Pump column for 2,2/4 Kw motor for Prof. BW3/MM3 + Adv. MP3/MA3/BF3
NA. 110001734 EBS 10097544	CRN 3-9+ Pump column for 3/5,5 Kw motor for Adv. MP4/MA4/BW4/BF4
NA. 110001735 EBS 10019054	CRN 3-15+ Pump column for 3/5,5 Kw motor for Adv. Dual pressure. MP1-DP/MA1-DP
NA. 110001732 EBS 10097546	CRN 5-9+ Pump column for 7,5/11 Kw motor for Adv. BW8/BW7+
NA: 110001736 EBS: 10106958	CRN 5-14+ pump column for 7.5/11 kW motor for Adv. BF8-16-24-32-40-48.

Chameleon pumps inclusive motor and electric connection check.

Item No.	Item text
NA. 110001755 EBS 10017207	CRN 3-9+ 2,2/4 kW motor electric connection checked eff1 Professional For BW3/MM3 produced before 17-03-2009
NA. 0604235 EBS: 10110286	CRN 3-9+ 2,2/4 kW motor electric connection checked eff1 Advanced MP3/MA3/BF3 and BW3/MM3
NA: 0604234 EBS: 10110963	CRN 3-9+ 3/5,5 kW motor electric connection checked eff1 Advanced BW4/MP4/MA4/BF4
NA. 110001754 EBS 10200703	CRN 3-15+ 3/5,5 kW motor electric connection checked eff1 Advanced dual pressure. MP1-DP/MA1-DP
NA. 0604232 EBS 10110302	CRN 5-9+ 7,5/11 kW motor electric connection checked eff1 Advanced BW8/BW7+
NA. 110000373 EBS 10200750	CRN 5-14+, 7,5/11 kW electric connection checked eff.1 For advanced BF8-16-24-32-40-48



Pump ALIGNMENT:

It is of great importance for both pump and pump column, that you follow the instructions from Grundfos when you install the pump/pump column. Please pay special attention to the adjustment of the pump column (impellers) inside the pump. Please see below Grundfos' adjustment guide:

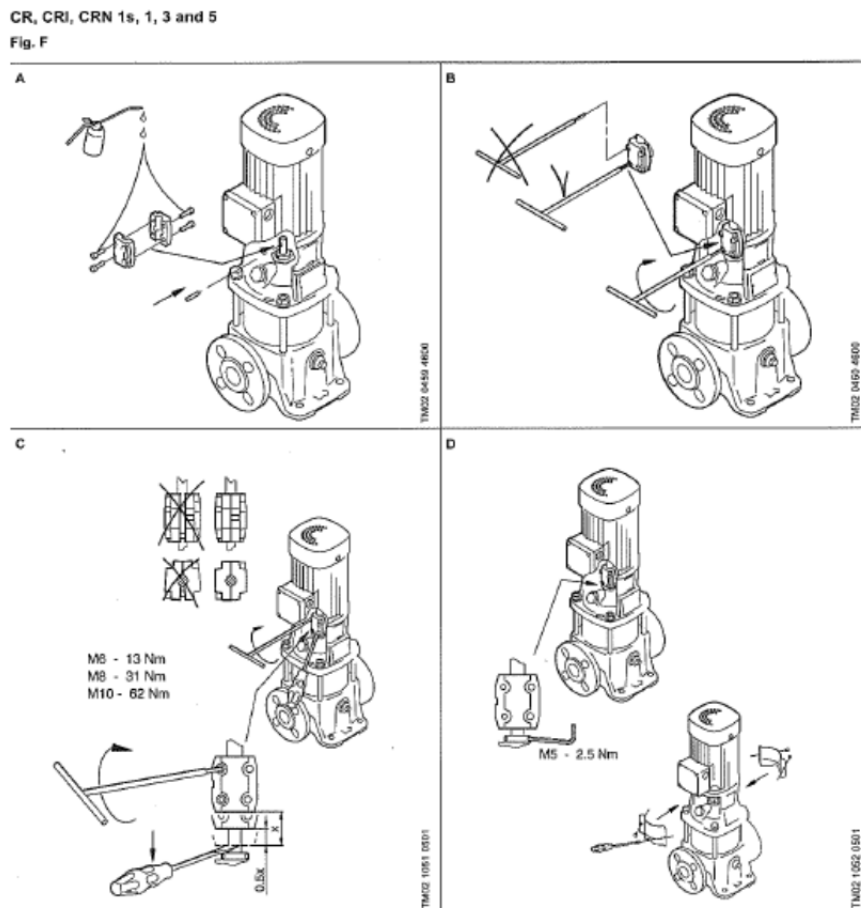

The above instructions are also visible on the inside of the cover of the pump coupling to the motor. When you receive the pump column a Grundfos instruction book is enclosed, describing how to connect the pump column to the motor.

Should you need any further information do not hesitate to contact
Nilfisk-ALTO Food Division sales department, direct tel. No.: +45 7218 2000.

Best regards
Nilfisk-ALTO Food Division

Niels Chr. Thygesen
Dir. tlf.: +45 7218 2006
Niels.christian.thygesen@nilfisk-alto.com